

Waterlase
express™



BIOLASE

Waterlase Express Cart
Instructions for Use

Waterlase Express Cart — Instructions for Use

Introduction

The Waterlase Express Cart was designed for the specific and exclusive use of the Waterlase Express all-tissue dental laser system and its accessories. It has been designed for transporting Waterlase Express within the dental office environment and also to facilitate the arbitrary positioning of the laser system for optimal use.

Please contact your authorized BIOLASE representative if you have any questions or require assistance.

Section 1: Safety

Please observe the following safety instructions:

General

- Personnel working directly or indirectly with the cart and its components should read the entire instructions for use prior to operating.
- Any modifications to this cart for anything other than its designed purpose will render its warranty null and void and may result in damage to the cart or injury to the user and/or bystanders.

Operation

- When transporting the cart within the facility, care should be taken to avoid obstructions and personnel.
- All drawers and doors should be in the closed position prior to any transport or repositioning to avoid damage or injury.
- All cords should be unplugged and stored in the designated cord storage area on the cart prior to movement within the facility.



Load Capacity

- Any maximum load ratings on any surfaces, drawers, etc. must be strictly observed to ensure safe and trouble-free use.
- The maximum load capacity for each drawer and door compartment is 1.5 kg.
- The maximum load capacity for the table top is 13 kg.
- The maximum load capacity for the cart is 19 kg.

Infection Precaution

- Standard disinfectants, such as CaviCide, can be used to wipe down the Waterlase Express Cart. However, **DO NOT** use bleach or abrasive cleaners on the Waterlase Express Cart or any of its components.
- Please clean and disinfect the cart between patients.

Section 2: Unpacking and Assembly

Unpacking

The Waterlase Express Cart comes in one shipping box. Use care when opening. Contents Include:

- A** Waterlase Express Cart (1 ea.)
- B** Waterlase Express Cart handle (1 ea.)
- C** Package of handle mounting hardware and tool (**Figure 1**)
- D** $\frac{5}{32}$ Hex Key (1 ea.)
- E** $\frac{1}{4}$ -20 Button Head Cap Screw (4 ea.)
- F** $\frac{1}{4}$ -20 Flat Washers (4 ea.)
- G** Instructions for Use (1 ea.)



Figure 1: Waterlase Express Cart Mounting Hardware and Tool

Handle Bar Assembly

Installation of the handle bar is the only item requiring assembly. The only tool required has been included in the hardware bag. To complete installation, please follow the instructions below:

1. Remove the hardware from the bag.
2. Place 1 washer (**item F**) on each of the four button head cap screws (**item E**) and set aside. See **Figure 2** for reference.

3. Raise the table top to its highest position by actuating the black lever underneath the table top. See **Figure 3** for reference.

CAUTION: At this time, there will be no weight on the table top and the gas spring within the column will have a positive force to it, resulting in the table top rising with force. Use caution that nothing is on or near the table top when carrying out this step to avoid risk of injury.

4. Position the handle (**item B**) over the table top (**item A**) and seat the location tabs of the handle into the designated handle locations in the table top.

NOTE: When properly positioned, the handle will “sweep” from the front of the cart towards the back. See **Figure (2)** for reference.

5. While holding the handle in this position with one hand, take one of the button head cap screws with washer and locate the mounting hole underneath the table top. By hand, carefully thread the button head cap screw into one of the holes until it catches completely. Repeat on both sides until all four button head cap screws are installed. See **Figure 2** for reference.
6. Taking the hex key (**item D**), tighten each button head cap screw until snug. Repeat on all four button head cap screws.
7. The handle is now installed and the cart is ready for use.

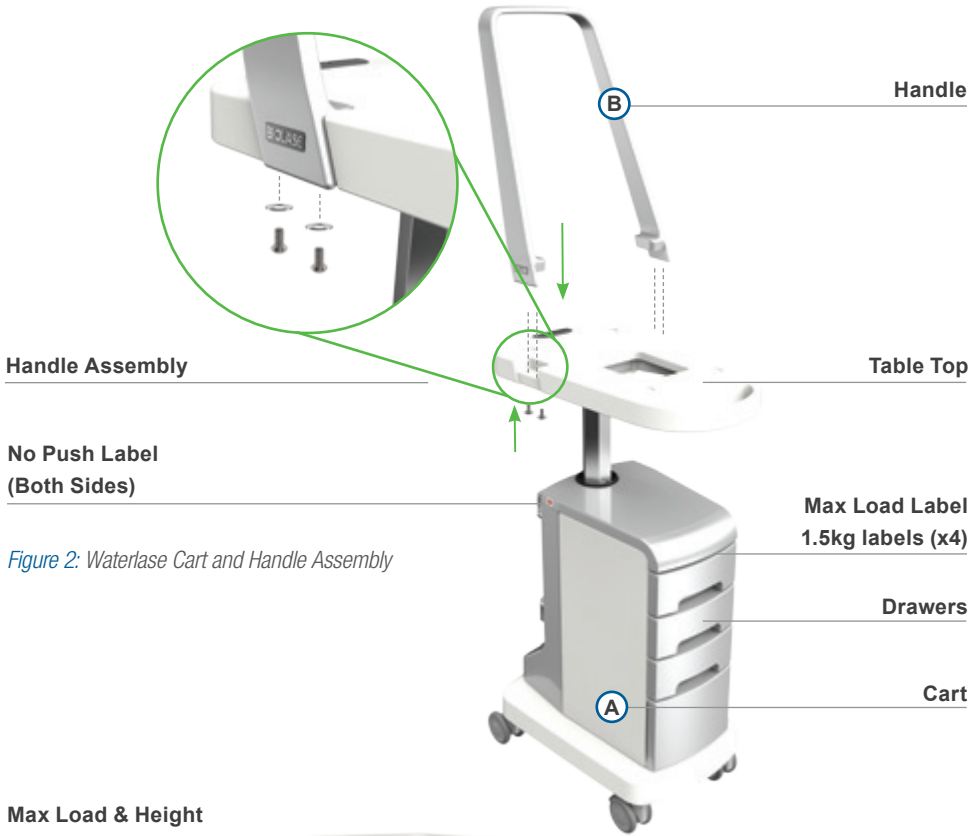

Figure 2: Waterlase Cart and Handle Assembly

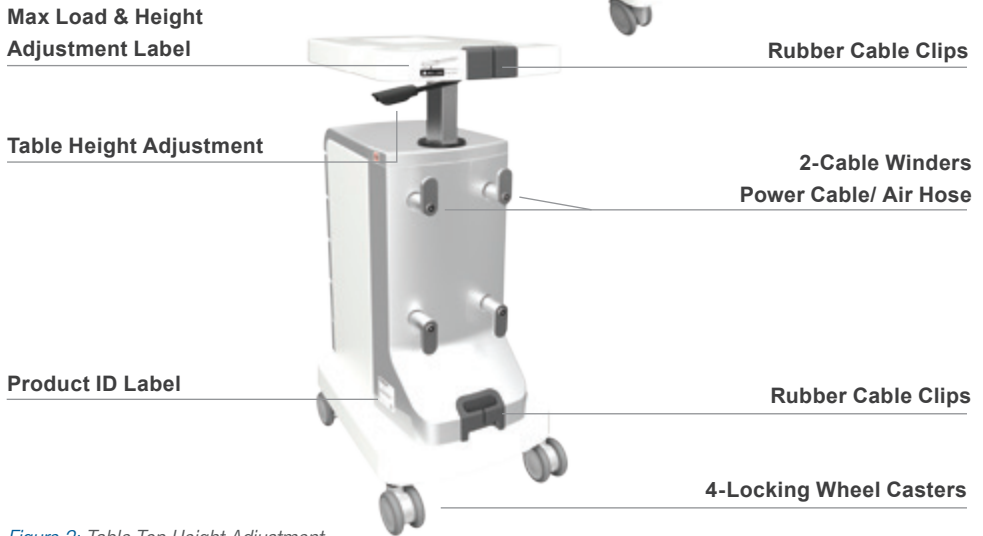

Figure 3: Table Top Height Adjustment

Section 3: Waterlase Express Installation

Once the handle has been installed, the cart is ready to receive the Waterlase Express for which it was designed.

CAUTION: Installation of equipment should only be done when the cart is on a smooth, level surface with all four (4) wheel castors locked.

- **Waterlase Express** – Set the laser console on the table top facing in the same direction as the cart front. Care should be taken to observe that there are four (4) debossments in the table top surface intended for the feet of the laser console, which allows it to sit securely on the table top, ensuring optimal safety.
- **Cable Winders** – The power cord for the laser console should be installed according to the instructions in the Waterlase Express User Manual. On the rear panel of the cart are two (2) sets of cable winders. Wind the power cable around one vertical set until secure, prior to the cart being transported. The other set of cable winders is for the air hose.
- **Drawers** – The drawers are for the exclusive use of components and accessories to be used with the laser. The maximum load per drawer should be observed for optimal functionality.

Section 4: Warnings and Precautions

Tilt Stability

Care has been taken in the design and manufacture of this cart to ensure maximum safety and stability when handled properly. It has been tested with the maximum load so that it will not tip when on

an inclined surface at an angle of 10 degrees. The maximum load is specified on the label located on the rear of the table top and in Section 1. The operator should have the cart in their manual control at all times during transport, and should never be pushed or pulled without complete control. Failing to observe this may result in injury or damage to the cart and equipment. Additional care should be taken when transporting over thresholds, cords, or any other obstructions.

CAUTION: It is recommended to lower table top to its lowest position before moving the cart. Do not push the cart from either side.

Locking Wheel Castors

The Waterlase Express Cart has been fitted with four (4) twin wheel castors with brakes on each castor. The brakes should be in the locked position to ensure maximum stability at all times. However, all brakes should be unlocked prior to any attempt being made to move the cart. Transporting the cart with any of the wheel castor brakes in the locked position may cause the cart to tilt, possibly resulting in injury or damage to the cart and equipment.

Section 5: Features and Operation

A number of features have been designed into the Waterlase Express Cart for ease of use.

Table Top Height Adjustment

The table top was designed with height adjustment positioning of the laser. It has been balanced to the combined weight of the table top, its handle, and the Waterlase Express all-tissue laser system only. Therefore, no other objects should be placed on the table top as it may interfere with the proper operation of the height adjustment feature.

The table top is automatically locked into position, unless the black actuator lever is activated. When the lever is activated, the table top can be moved up or down with minimum effort.

- From the back of the cart, locate the black actuator lever under the table top. (**Figure 4**)
- Grasp the table top on either side with **both hands**.
- With the left hand, squeeze actuator lever with your fingers in an upwards fashion.
- While holding the lever in this position, push or pull the table top vertically to the desired position.
- When desired height is reached, release the lever.



Figure 4: Table height Adjustment Lever, hold table top with hands while using lever

Rubber Cable Clips

At the rear of the table top and at the rear bottom of the cart cabinet, you will find one (1 each) black rubber cable clips. Each of these has a split in the center of them. The purpose of these clips is to guide and keep the cable and tubing in an orderly flow from the device to its source. (**Figure 5**)

- Push the cable between the split in the table top clip.
- Repeat for the bottom clip.
- To disengage from the clip, gently pull the cable out through the split in the clip.

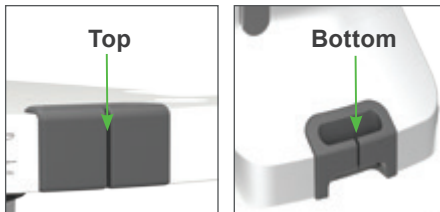

Figure 5: Rubber cable clips at top and bottom of cart

Cable Storage Winders

On the rear side of the cart are two pair of cable winders, onto one of which the power cord is stored. (**Figure 6**)

- Grasp the cord from the rear of the laser console and route the cable down the back of the cart until the cord reaches the bottom of one of the winders.
- Loop the cord underneath the winder and route the cord upwards to the top winder.
- Loop the cord over the top winder and repeat until the cord is completely stored.
- Each cable winder includes rotating tabs to facilitate immediate removal of its stored cord.
- To remove the cord, rotate the top and bottom cable winder tab 180 degrees (i.e., both tabs facing in the opposite direction of its home position), and slide the wound cord off of the cable winders. Reorient each tab to its home position (180 degrees) afterwards.



Figure 6: 2-cable storage winders back of cart

Wheel Castors

There are four (4) locking wheel casters located on the bottom of the cart. The casters should be kept locked at all times when the cart is not being moved for maximum stability.

- To lock the castor, depress the brake lever located at the front of the castor until it clicks. (**Figure 7**)
- To unlock the castor, lift the brake lever located at the front of the castor until it clicks. (**Figure**

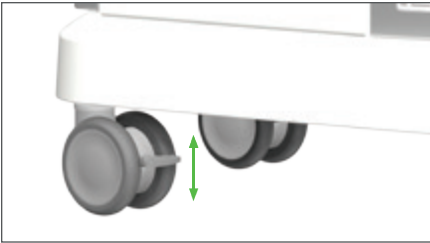

Figure 7: 4-locking breaks, press down to lock, lift up to release

CAUTION: Use care when pushing or pulling the cart. Never push or pull the cart when the wheels are locked.

Section 6: Technical Data

Load Capacity

Table top payload	13 kg/28 lb
Drawers payload	1.5 kg/3 lb (4.5 kg/9 lb total)
Lower storage compartment payload . . .	1.5kg/3 lb
Total payload19 kg/41.9 lb (4.5 kg/9 lb total)

Weight

Empty	25 kg/55 lb
With payload44kg/97 lb (cart + maximum payload)

Section 7: Labels

Product ID Label

Location: Side of cart



Max Load Table Top Label

Maximum load allowed on the table top and indicates operation of the table top adjustment lever

Location: Back of table top

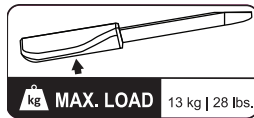

Max Load Drawer Label

Do not exceed max load allowed

Location: On each drawer and door

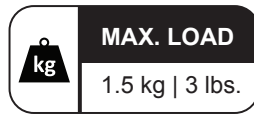

No Pushing

Do not push the cart on either side as cart may tip over

Location: Both sides of cart



Section 8: Service, Warranty and Liability

Service

Should the Waterlase Express Cart require service, it must be shipped back to the manufacturer. Should the Waterlase Express Cart need to be disposed, please dispose in accordance to local regulations.

Limited Warranty

For warranty information, refer to separate equipment warranty.

Limited Liability

BIOLASE, Inc. will not be liable for incidental, consequential, indirect or special damages of any kind including, but not limited to, damages for loss of revenue, loss of business or business opportunity or other similar financial loss arising out of or in connection with the performance, use or interrupted use of the BIOLASE diode laser system(s) or any BIOLASE materials.

BIOLASE



BIOLASE, Inc.

4 Cromwell, Irvine, CA 92618 USA

949.361.1200 • 888.424.6527 • biolase.com